

This page lists the contents included in the box. Please take time to identify the hardware as well as the individual components of the product. As you unpack and prepare for assembly, place the contents on a carpeted or padded area to protect them from damage. Please follow the assembly instructions closely. Improper assembly can result in personal or property damage.

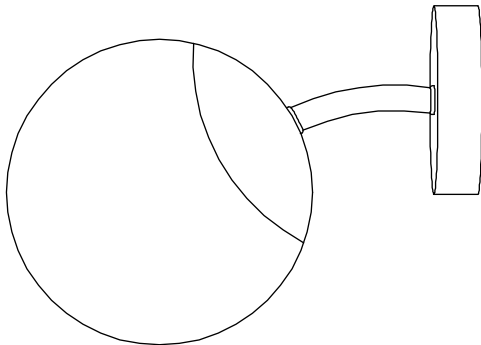

IMPORTANT SAFETY INSTRUCTIONS:
 If you are unsure about what mounting method you should use, consult a qualified professional or your local hardware store.
 We recommend installation of this lamp be performed by a licensed electrician.

hardware



2 - large screws



2 - small screws



3 - wire nuts

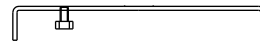

1 - mounting plate

tools required

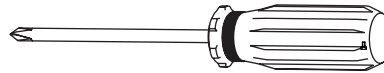

phillips head screwdriver



electrical tape

cleaning & care

Dust surfaces with a dry soft cloth. Do not use cleaners or polishes on the lamp.

components

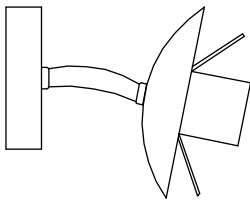

1- lamp fixture

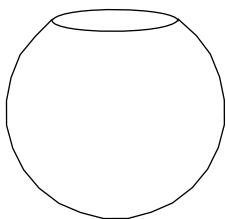

1- shade



1- 40 watt max type G19 1/2 bulb (NOT INCLUDED)

1

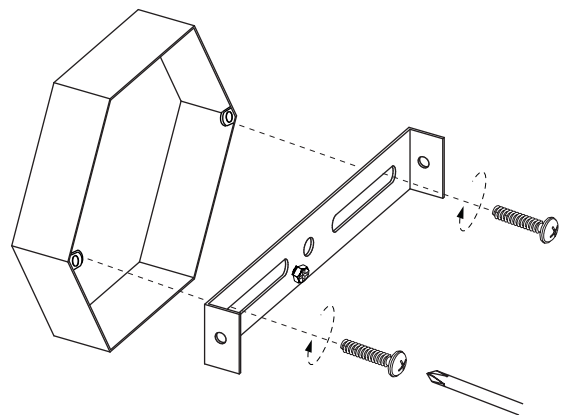

Shut off the main electrical supply from the main fuse box/circuit breaker. Carefully unpack all fixture parts and hardware. Lay items out on a clear workspace.

Align holes in **mounting plate** with corresponding holes in the junction box. Attach mounting plate with **2 large screws**, and secure with a **phillips head screwdriver**.

2

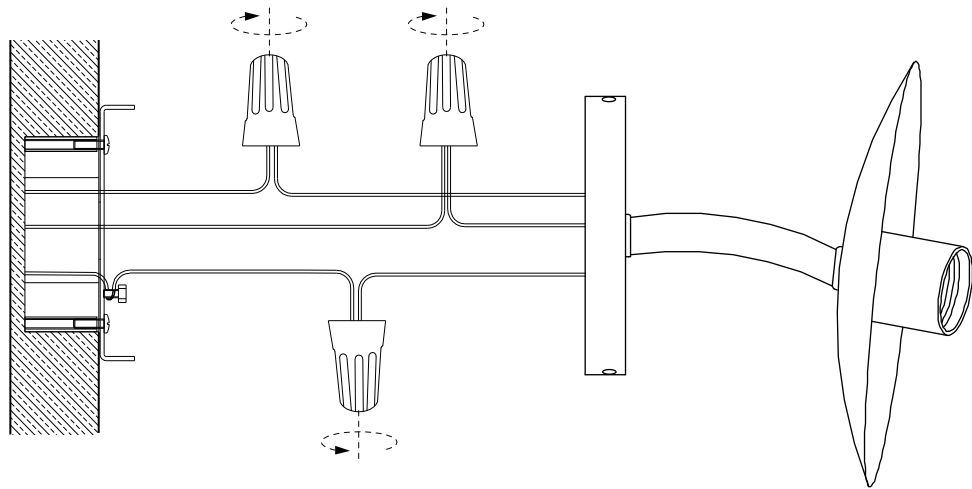

Carefully inspect the fixture wires:

- Neutral fixture wire = *white*
- Hot fixture wire = *black*
- Ground wire = *green*

- Wrap the *ground* wire of the junction box around the the *ground* screw on the **mounting plate** and secure with a **phillips head screwdriver**. Fasten the open end of the *ground* wire from the junction box to the *ground* wire from the lamp with a **wire nut**, and wrap the connection with **electrical tape**.
- Attach the *neutral* fixture wire from the lamp to the *neutral* junction box wire (usually white). Fasten each together with a **wire nut** and wrap the connection with **electrical tape**.
- Attach the *hot* fixture wire from the lamp to the *hot* junction box wire (usually black). Fasten each together with a **wire nut** and wrap the connection with **electrical tape**.

3

A. Neatly tuck wires into the junction box. Fit **lamp fixture** into position, aligning holes of fixture with corresponding holes in the mounting plate. Secure with 2 **small screws**.

B. Insert 1 **bulb** into the socket of the lamp fixture. **DO NOT EXCEED SPECIFIED WATTAGE.**

C. Squeeze prongs of lamp fixture and fit **shade** onto fixture as shown. Release prongs to secure.

Restore power to junction box and test fixture. Installation is now complete.

