

Thank you for purchasing the **Twine Floor Lamp**. This page lists all the contents included in the box. Please take the time to identify the hardware as well as the individual components to this product. As you unpack and prepare for assembly, place the contents on a carpeted or padded area to protect them from damage. Note: 2 people are required to safely assemble this product.

tools required

allen wrench (included)

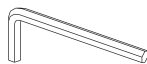

phillips head screwdriver

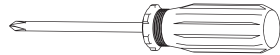

(We recommend the use of hand tools instead of power tools)

components



1 - socket
(with cord)

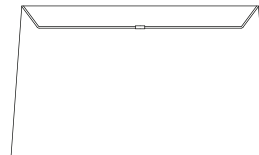

1 - lampshade

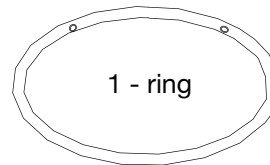

1 - ring



5 - set
screws

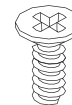

5 - bolts



1 - standard type
"A" bulb
(150 watt max)
NOT INCLUDED



1 - harp



1 - finial

5 - uprights

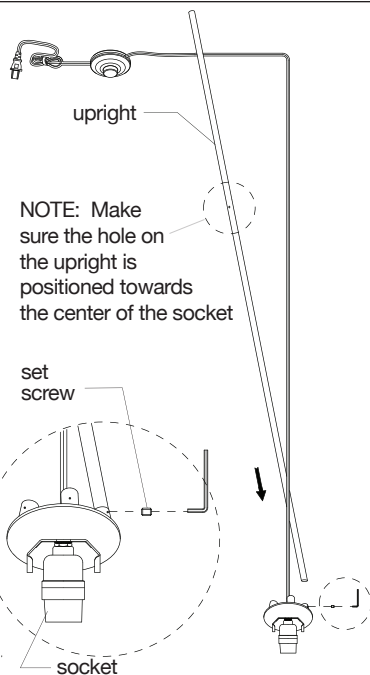

NOTE: Make sure the hole on the upright is positioned towards the center of the socket

set screw

1 Fit **upright** into base of **socket**. Loosely attach with 1 **set screw** as shown, using an **allen wrench**. Do not fully tighten the screw until further instructions.

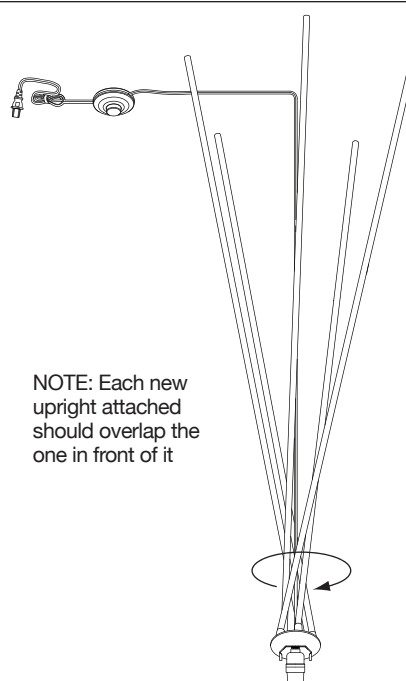

NOTE: Each new upright attached should overlap the one in front of it

2 Repeat step1 for each remaining **upright**, making sure to attach uprights going counter clockwise from right to left.

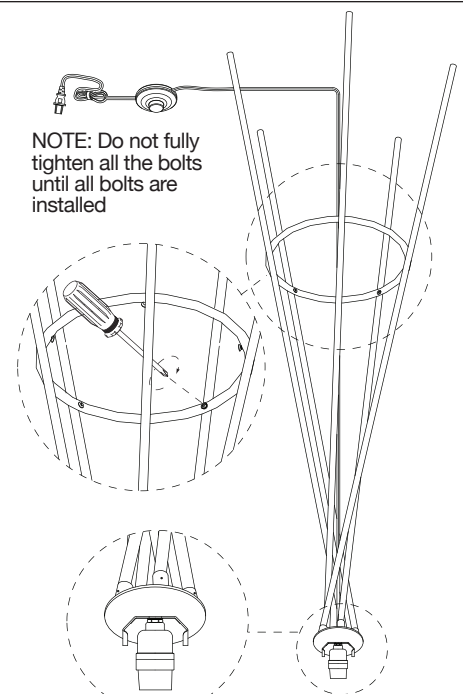

NOTE: Do not fully tighten all the bolts until all bolts are installed

3 Loosely attach **ring** to each **upright** with 1 **bolt** as shown, using a **phillips head screwdriver**. At this point, fully tighten all **set screws** and **bolts**.

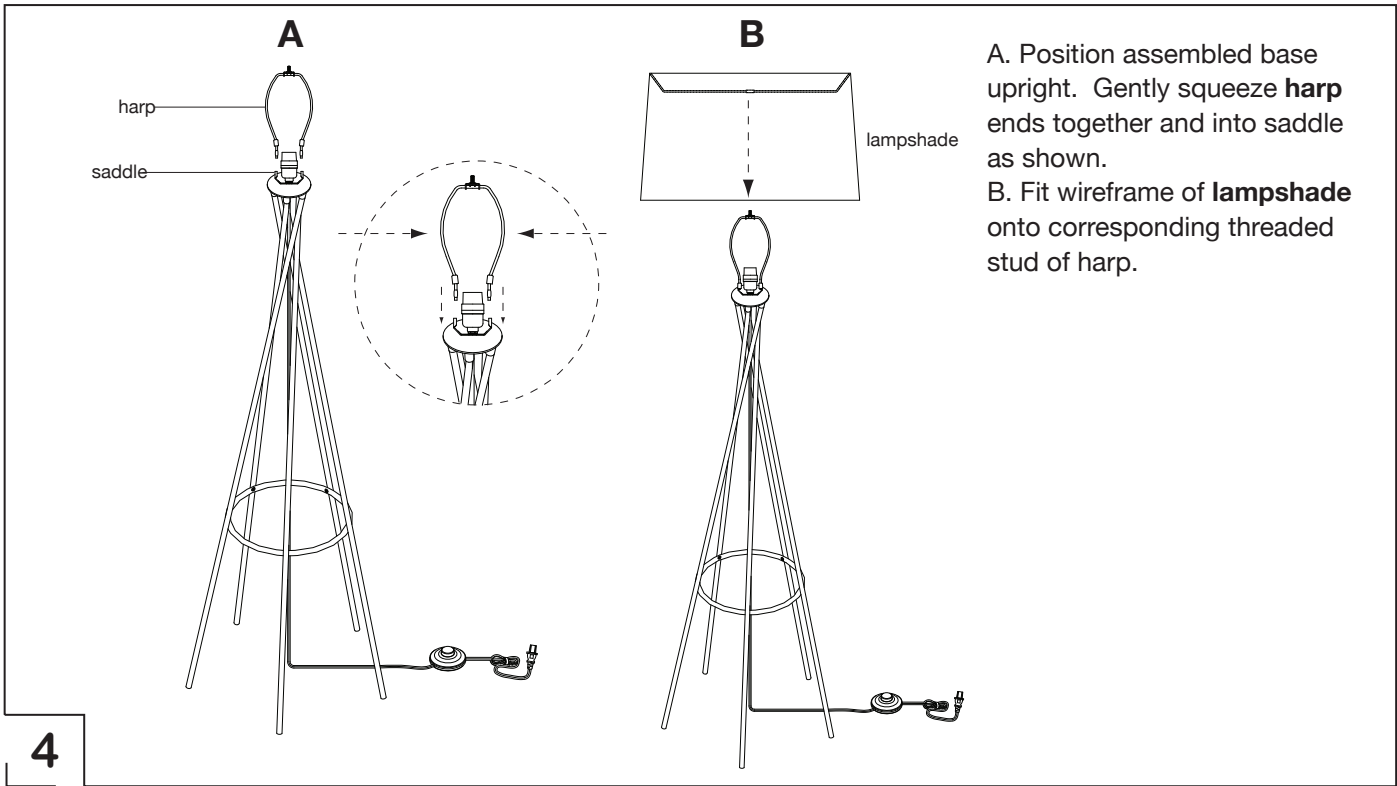

A. Position assembled base upright. Gently squeeze **harp** ends together and into saddle as shown.
B. Fit wireframe of **lampshade** onto corresponding threaded stud of harp.

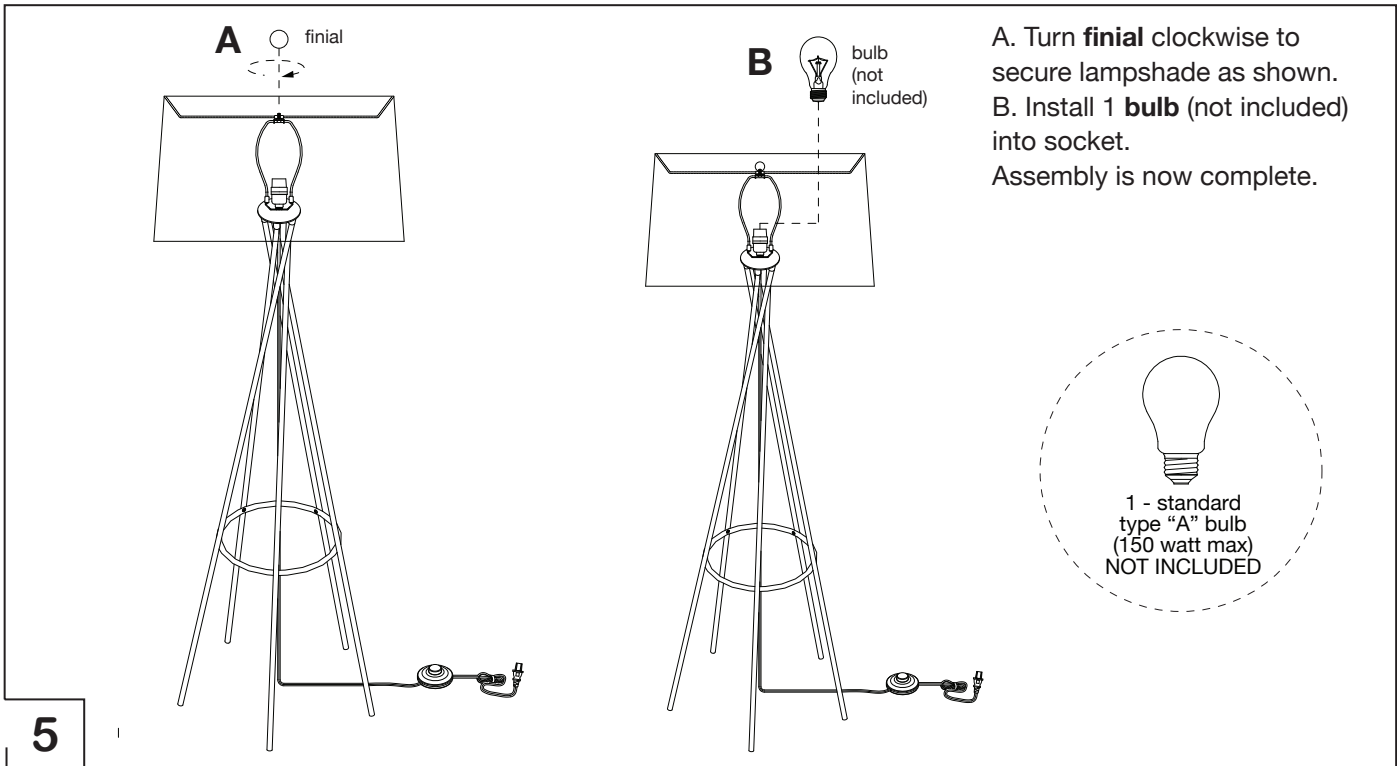

A. Turn **finial** clockwise to secure lampshade as shown.
B. Install 1 **bulb** (not included) into socket.
Assembly is now complete.

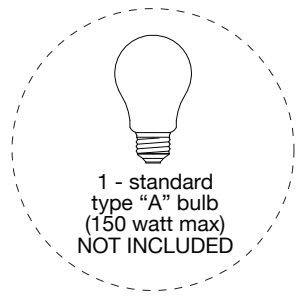

CLEANING AND CARE: Do not use polishes or cleaners on your lamp. Dust surfaces with a dry soft cloth.
IMPORTANT SAFETY INSTRUCTIONS: This portable lamp has a polarized plug (one blade is wider than the other) as a safety feature to reduce the risk of electric shock. This plug will fit in a polarized outlet only one way. If the plug does not fit fully in the outlet, reverse the plug. If it still does not fit, contact a qualified electrician. Never use with an extension cord unless plug can be fully inserted. Do not attempt to override this safety feature.