

Thank you for purchasing the **Skinny Dip Side Table**. This page lists all the contents included in the box. Please take the time to identify the hardware as well as the individual components to this product. As you unpack and prepare for assembly, place the contents on a carpeted or padded area to protect them from damage.

Note: 2 people are required to safely assemble this product.

hardware

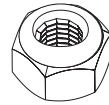

10 - hex nuts

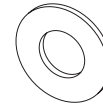

10 - washers

Missing hardware?
Please call **800.606.6387** for replacements.

tool required

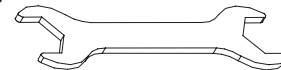

hex wrench (included)

components

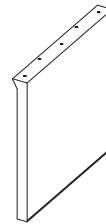

2 - legs
(1 - A, 1 - B)

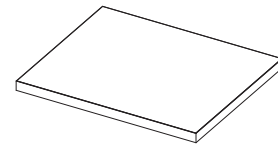

1 - tabletop

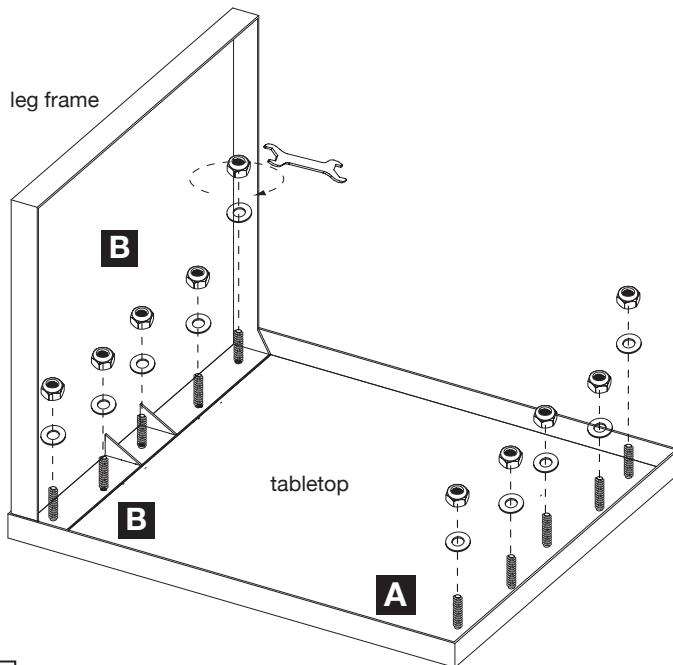

assembly

Place **tabletop** upside down onto a clean, padded surface as shown. Locate label marked **A** on the **tabletop**. Fit threaded studs of **tabletop** into corresponding holes of 1 **leg A** as shown. Using a **hex wrench**, secure 1 **hex nut** and 1 **washer** to each threaded stud. Repeat steps label marked **B** for **leg B**. Position unit upright. Assembly is now complete.

1

NOTE: Do not over tighten the nuts

cleaning & care

Clean surfaces with a dry or damp soft cloth. Do not use abrasive cleaners. Do not use furniture wax or polish as the unit is finished with a protective clear lacquer. It is recommended to use coasters to protect surface from heat and water. Please note that each table is unique and variances in the finish are inherent.