

Thank you for purchasing the **Phoos Table**. This page lists all the contents included in the box. Please take the time to identify the hardware as well as the individual components to this product. As you unpack and prepare for assembly, place the contents on a carpeted or padded area to protect them from damage. Note: 2 people are required to safely assemble this product.

hardware

- #10
 16 - bumpers
- #11
 16 - plastic washers
- #15
 8 - small allen bolts
- #16
 20 - metal washers
- #17
 12 - large allen bolts
- #18
 8 - small phillip bolts
- #19
 8 - medium phillip bolts
- #20
 26 - large phillip bolts
- #21
 4 - leg levelers

Missing hardware?
Please call **800.606.6387** for replacements.

tools required

- allen wrench (included)
 - philips head screwdriver
- (We recommend the use of hand tools instead of power tools)

components

- #1
 1 - table assembly
- #2
 4 - legs
- #3
 8 - rod end caps
- #4
 2 - leg end panels
- #5
 4 - 3 man rods
- #6
 2 - 2 man rods
- #7
 2 - 5 man rods
- #8
 13 - A players
- #9
 13 - B players
- #12
 8 - rod handles
- #13
 2 - soccer balls
- #14
 2 - soccer balls

assembly

NOTE: Do not over tighten the bolts.

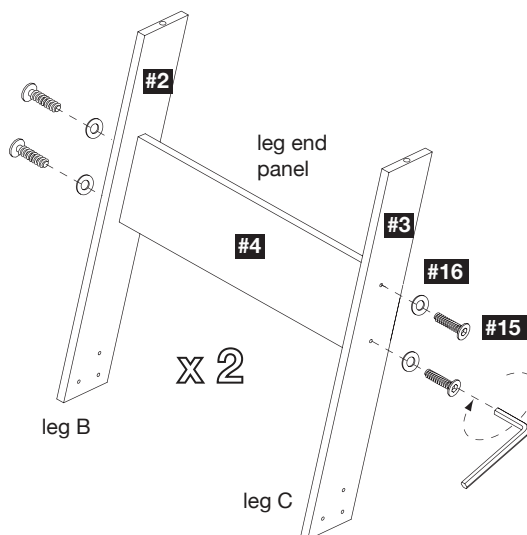

Attach 1 **leg B** and 1 **leg C** with 1 **leg end panel**. Secure each **leg** to **leg end panel** with 2 **metal washers** and 2 **small allen bolts** as shown. Secure, but do not over tighten, bolts using an **allen wrench**. Repeat steps for remaining **leg end panel** and **legs**.

1

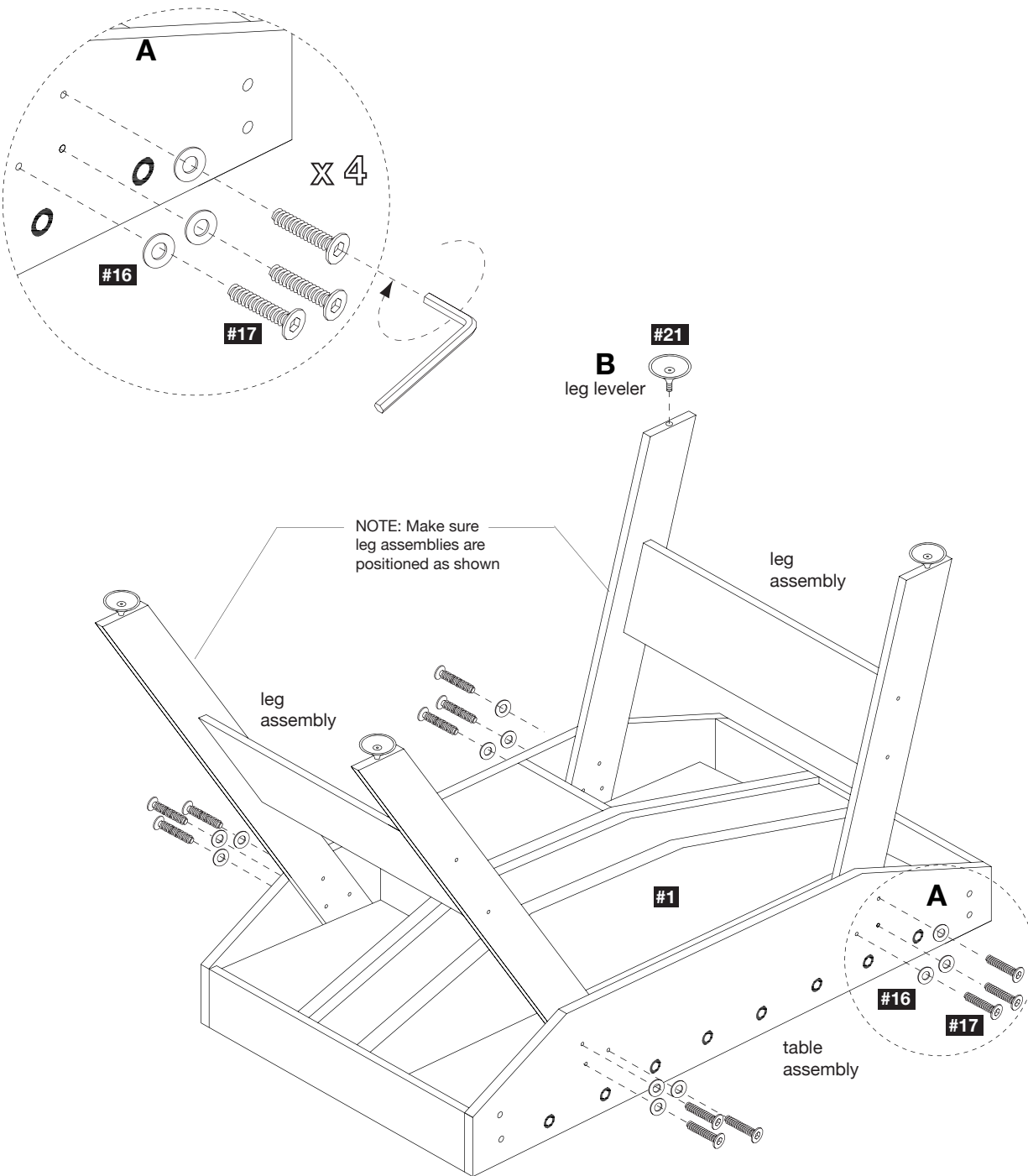

A. With the assistance of another adult, place **table assembly** upside down onto a clean, padded surface. Attach 2 **leg assemblies** to **table assembly** with 6 **metal washers** and 6 **large allen bolts** per leg assembly as shown. Secure using an **allen wrench**.

B. Attach 4 **leg levelers** to each **leg** as shown. Turn each leg leveler clockwise to secure.

C. With the assistance of another adult, position unit upright. If table is not level, adjust each leveler by turning clockwise or counter clockwise.

2

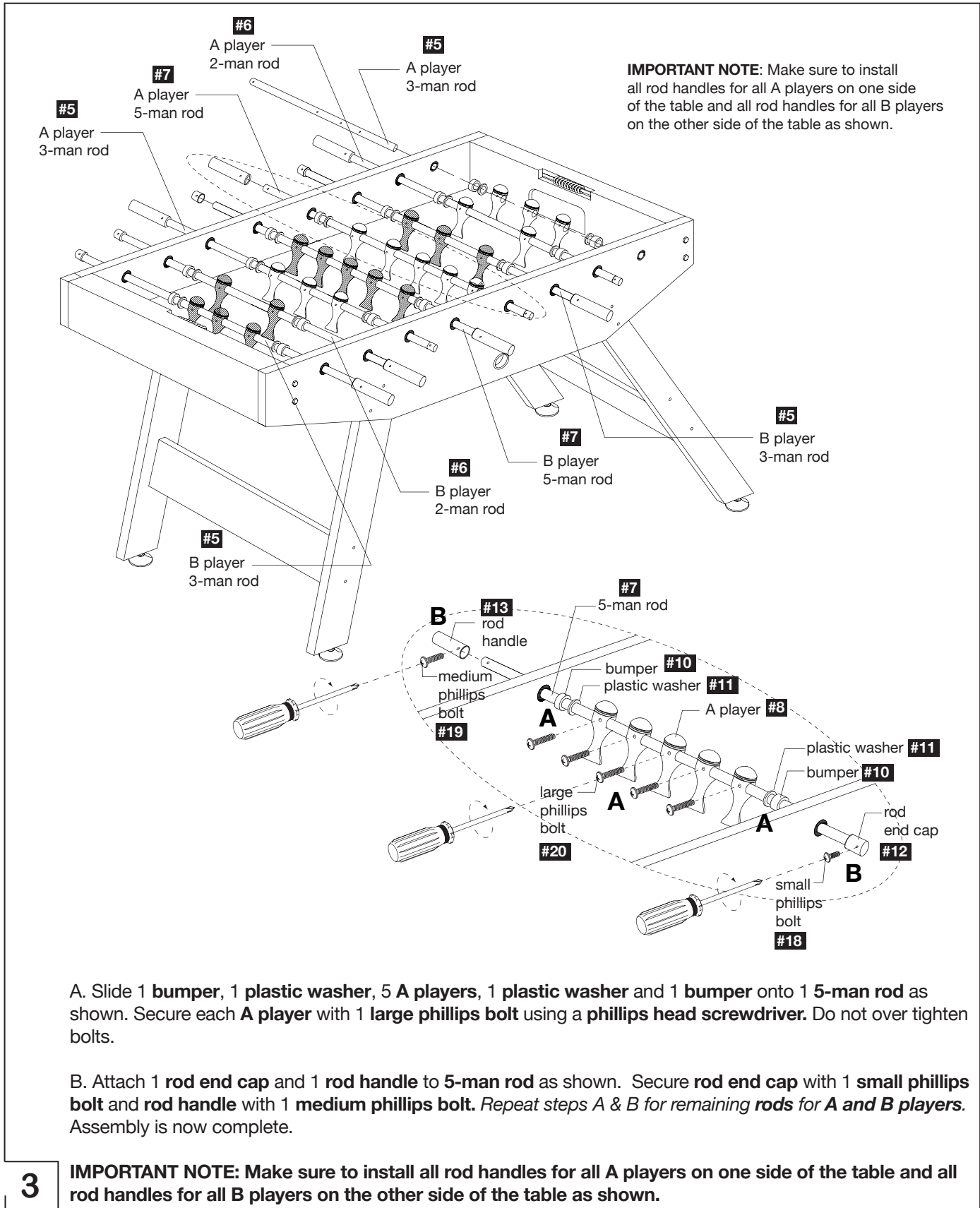

A. Slide 1 bumper, 1 plastic washer, 5 A players, 1 plastic washer and 1 bumper onto 1 5-man rod as shown. Secure each A player with 1 large phillips bolt using a phillips head screwdriver. Do not over tighten bolts.

B. Attach 1 rod end cap and 1 rod handle to 5-man rod as shown. Secure rod end cap with 1 small phillips bolt and rod handle with 1 medium phillips bolt. Repeat steps A & B for remaining rods for A and B players. Assembly is now complete.

3 **IMPORTANT NOTE:** Make sure to install all rod handles for all A players on one side of the table and all rod handles for all B players on the other side of the table as shown.

cleaning & care | Clean surfaces with a dry or damp soft cloth. Do not use abrasive cleaners.