

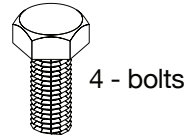

Thank you for purchasing the **Laird Desk**. This page lists all the contents included in the box. Please take the time to identify the hardware as well as the individual components to this product. As you unpack and prepare for assembly, place the contents on a carpeted or padded area to protect them from damage.
 Note: 2 people are required to safely assemble this product.

hardware



Missing hardware?
 Please call **800.606.6387** for replacements.

tools required

hex wrench (included)

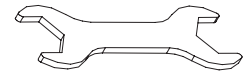

components

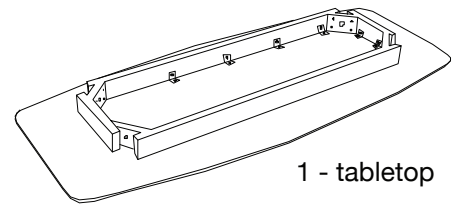
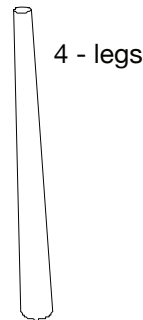

assembly

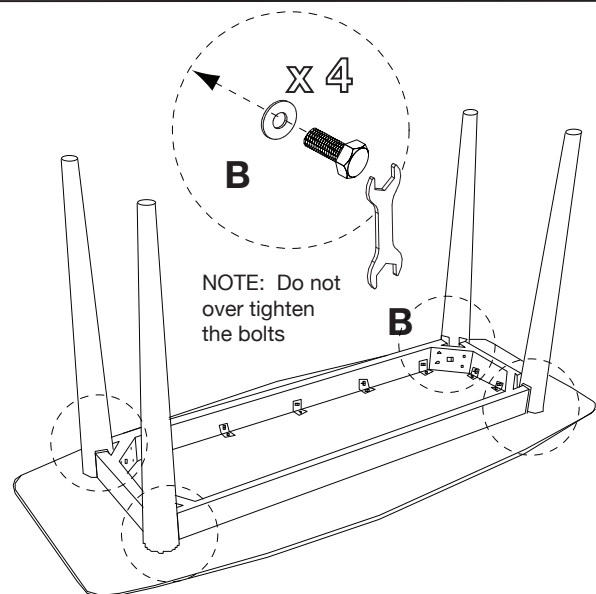
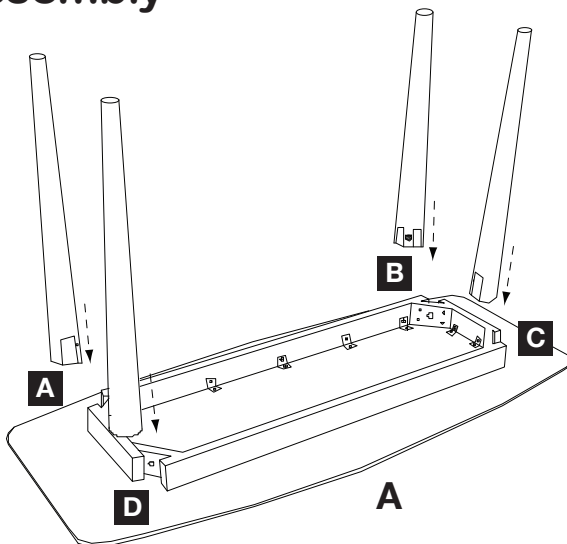

1 A. Place **tabletop** upside down onto a clean, padded surface as shown. Locate letters on each **leg**. Fit **leg** with corresponding letter into apron of **tabletop**.

B. Attach each **leg** with 1 **bolt** and 1 **flat washer**. Secure, but do not over tighten, with a **hex wrench**. Assembly is now complete.

cleaning & care

Clean surfaces with a dry cloth. Do not use abrasive cleaners. Furniture wax can be used, as this items has already been finished with a natural wax over a protective clear lacquer. It is recommended to use coasters to protect surface from heat and water.