

Thank you for purchasing the **House Number**. This page lists all the contents included in the box. Please take the time to identify the hardware as well as the individual components to this product. As you unpack and prepare for assembly, place the contents on a carpeted or padded area to protect them from damage.

**NOTE: If you are unsure about your wall type or what mounting method you should use, consult a qualified professional or your local hardware store.**

## hardware



2 - screws



2 - plastic anchors

Missing hardware?  
Please call **800.606.6387** for replacements.

## tools required

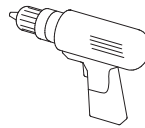

1/4" dia drill  
(for pilot holes only)

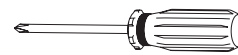

Phillips head  
screwdriver

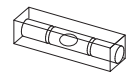

level

## components



1 - house number



1 - wall template

## wall mounting assembly

For safe mounting, it is essential to use wall anchors appropriate to your wall type (i.e. plaster, drywall, concrete, etc.). Mount to wood studs whenever possible.

- Determine the location for the **house number**. Using a **level**, position **wall template** and mark 2 hole positions on the wall.
- Drill pilot holes in the wall stud. If a wall stud is not available, drill holes in the wall slightly smaller in diameter than the anchors. Gently tap **plastic anchors** into holes until the flange of each anchor is flush to the wall. Insert 1 **screw** into each **plastic anchor** as shown, using a **screwdriver**. Leave approximately 1/4" of the screw head protruding from the wall.
- Align keyholes on back of **house number** with screws and fit securely onto screw heads. Make sure unit is securely supported by both screws. Installation is now complete.

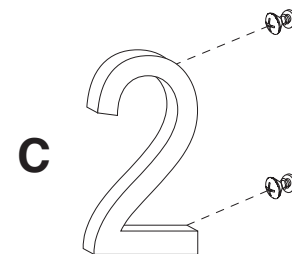
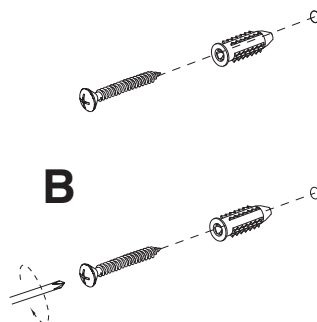
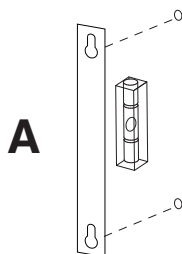

## cleaning and care

Clean surfaces with a dry or damp soft cloth. Do not use abrasive cleaners.