

Thank you for purchasing the **Hide 'n Seek Wall Storage Shelf**. This page lists all the contents included in the box. Please take the time to identify the hardware as well as the individual components to this product. As you unpack and prepare for assembly, place the contents on a carpeted or padded area to protect them from damage.

Note: 2 people are recommended to safely install this product.

hardware

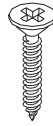

4 - screws



4 - plastic anchors

Missing hardware?
Please call
800.606.6387 for
replacements.

components



1 - wall
bracket



1 - shelf
assembly

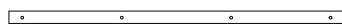

1 - wall template

tools required



tape

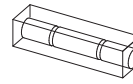

level

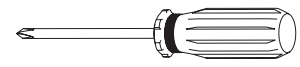

phillips head screwdriver

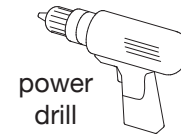

power
drill

For safe mounting, it is essential to use wall anchors appropriate to your wall type (i.e. plaster, drywall, concrete, etc.). Mount to wood studs whenever possible.

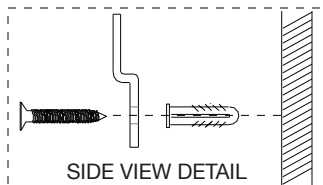

SIDE VIEW DETAIL

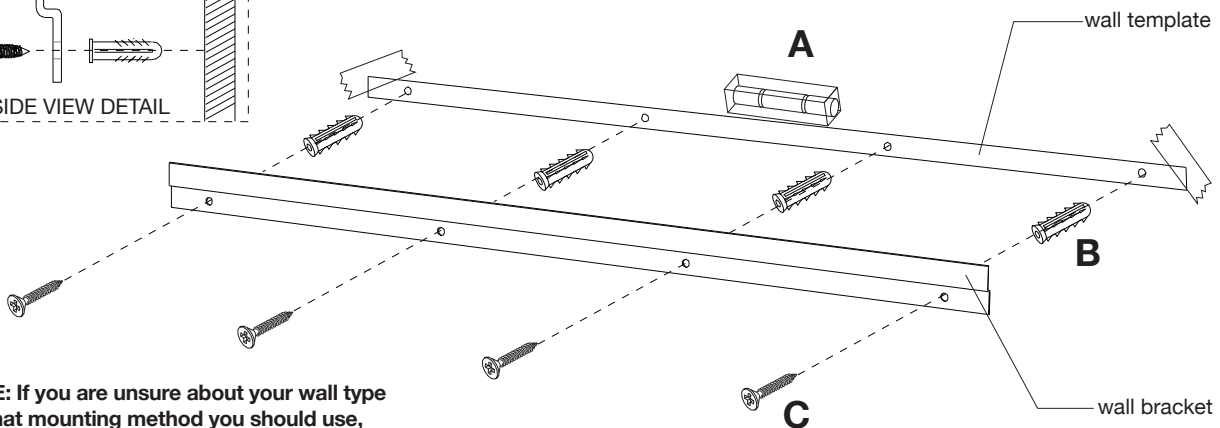

WALL

NOTE: If you are unsure about your wall type or what mounting method you should use, consult a qualified professional or your local hardware store.

A. Determine the final location of the shelf assembly. Place the **wall template** onto the wall as shown. If possible, position template so at least 1 hole is aligned with a wall stud. Using a **level**, adjust the template until it is level and adhere to wall using **tape**.

B. Drill a pilot hole in the wall stud. If a wall stud is not available, drill a hole in the wall that is slightly

smaller in diameter than the anchor. Remove template. Insert 4 **plastic anchors** into the holes and gently tap until each anchor head is flush to the wall surface.

C. Insert 4 **screws** through the **wall bracket** and into the anchors in the wall as shown. Secure, but do not over tighten, with a **phillips head screwdriver**.

1

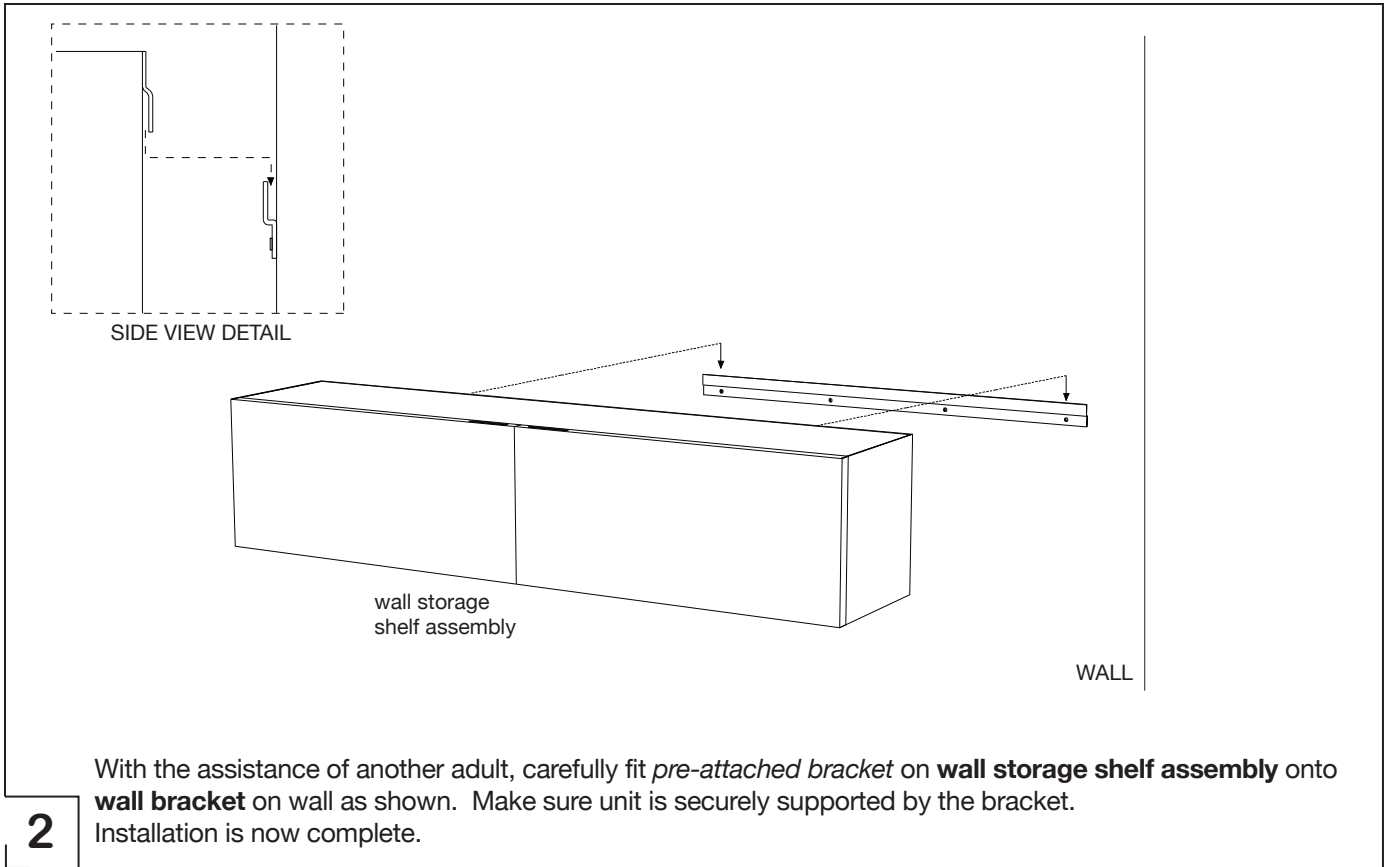

CLEANING AND CARE

Clean surfaces with a dry or damp soft cloth.
Do not use abrasive cleaners.

NOTE: This item is able to support up to a total of 120lbs evenly distributed.